

Callmaster fire and security systems

Material

PVC-U is flame retardant and self extinguishing. It provides a 100% recyclable material with good sustainability. It complies with the requirements of BS 4761 Parts 6 and 7 and BS 4678. The Callmaster system is designed to comply with BS 7671:2008.

Installation

- Select Terminal or through box to suit installation.
- If a terminal box is used, fit the blanking plate to unused entry.
- Depending upon circuit wiring, select MIC internal Pot retainer or cable Fibre clamp. Both components are suitable for single or twin cable runs.
- Insert one half of the retainer/clamp into the surface box (from the rear) and secure box to the wall.
- Lay in MIC or cable and secure in position with top half of retainer/clamp – fit Mini adaptor.
- Terminate wiring to accessory and fit to box.

Boxes

Dimensional data for square boxes

- Overall: 87 x 87mm
- Depth: 38mm external; 35mm internal
- Fixing centres: 60.3mm
- Pot size: Ø15mm

Dimensional data for circular boxes

- Overall diameter: 123mm excluding adaptors
- Depth: 28mm external; 24mm internal
- Dual fixing centre: 50.8 and 60.3mm
- Pot size: Ø15mm

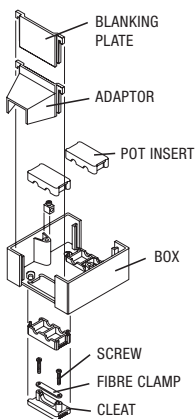

Mini trunking additional adaptors

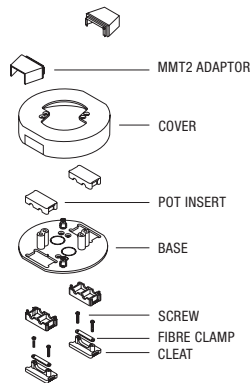

Intumescent (fire barrier) pads

Marshall-Tufflex dry lining boxes are available with intumescent (fire barrier) pads to comply with the requirements of BS 7671:2008 IEE Wiring Regulations and Document B of the UK Building Regulations.

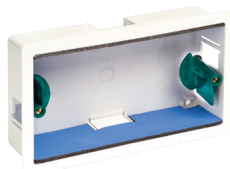

Firefly Fire Clips

Standards

Compliant with the general principles of BS 5839-1:2013 Section 26.2d when independently tested.

Installation

Vertical spacing – Use 400mm spacing
Horizontal spacing – Use 600mm spacing, except over doors and other openings which should be 300mm spacing.

A qualified electrician must select the correct screw fixing for the substrate to comply with BS 7671 Amendment 3. These must be used with the correct drill size.

Dimensions

FCCR20

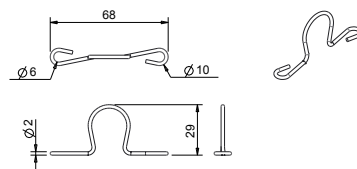

FCCR25

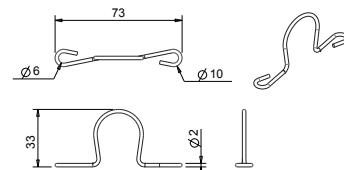

FCMMT2

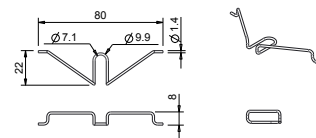

FCMMT3

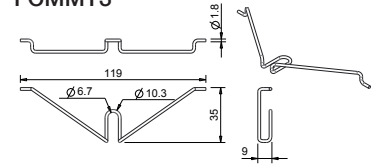

FCMMT4

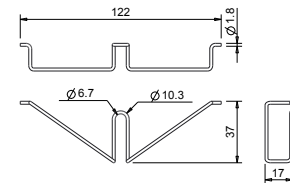

FCMMT5

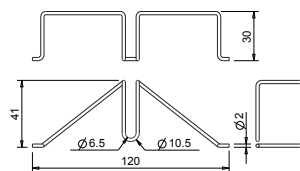

FCMMT6

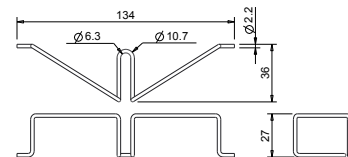

FCMTRS50

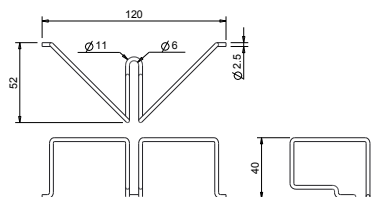

FCXMMT2

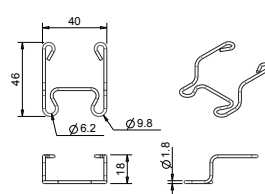

FCXMMT4

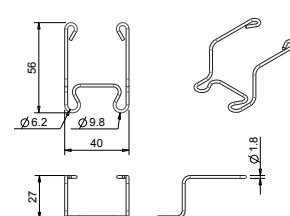

p235

Product Information